

# CONNECTORS

A6E201700006M01

## Data Link Connector

- Insert the probe into the service hole when connecting a jumper wire to the data link connector.

### Caution

- Inserting a jumper wire probe into the data link connector terminal may damage the terminal.

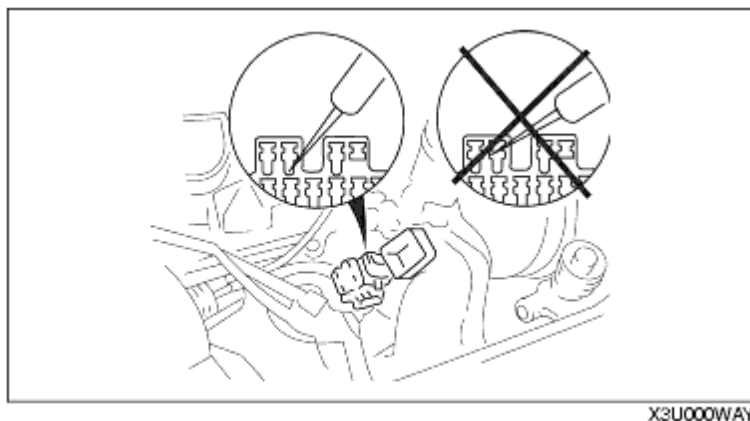

## Disconnecting Connectors

- When disconnecting connector, grasp the connectors, not the wires.

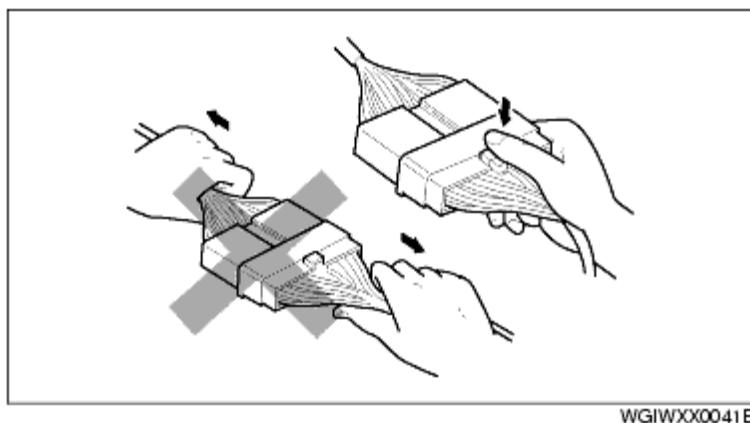

- Connectors can be disconnected by pressing or pulling the lock lever as shown.

## Locking Connector

- When locking connectors, listen for a click indicating they are securely locked.

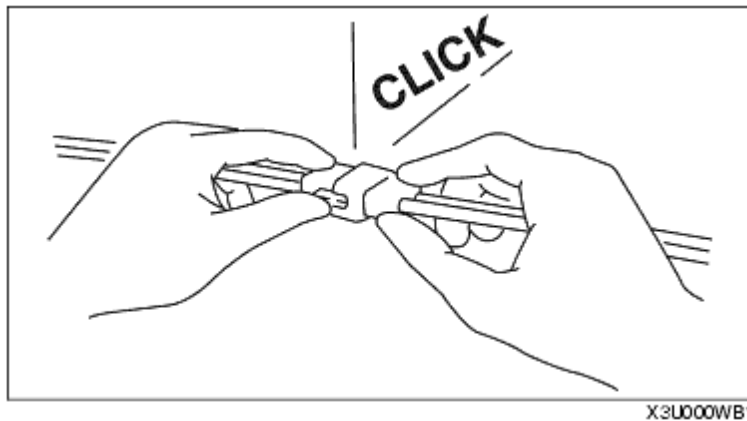

## Inspection

- When a tester is used to inspect for continuity or measuring voltage, insert the tester probe from the wiring harness side.

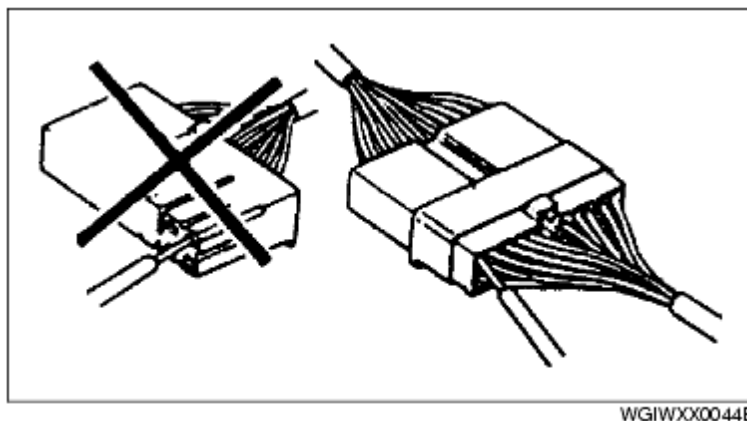

- Inspect the terminals of waterproof connectors from the connector side since they cannot be accessed from the wiring harness side.

### Caution

- To prevent damage to the terminal, wrap a thin wire around the tester probe before inserting into terminal.

## Terminals

### Inspection

- Pull lightly on individual wires to verify that they are secured in the terminal.

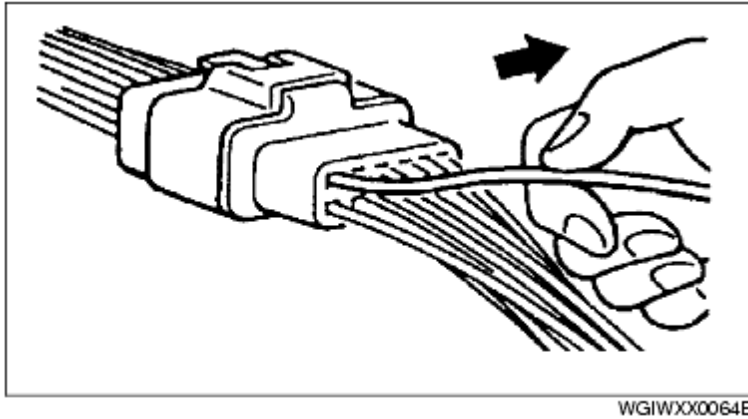

### Replacement

- Use the appropriate tools to remove a terminal as shown. When installing a terminal, be sure to insert it until it locks securely.
- Insert a thin piece of metal from the terminal side of the connector and with the terminal locking tab pressed down, pull the terminal out from the connector.

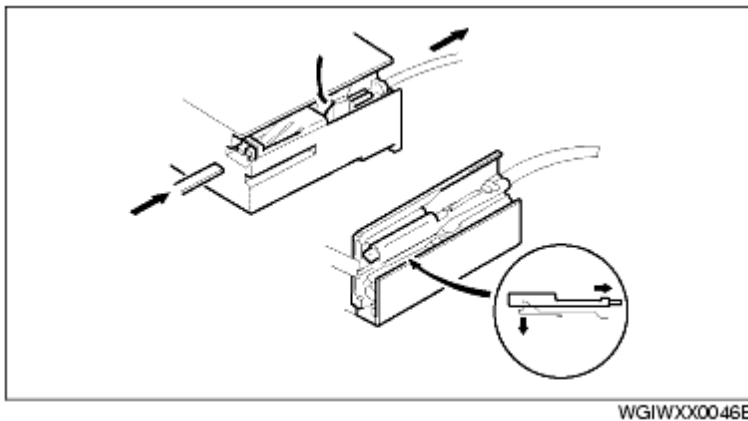

## Sensors, Switches, and Relays

- Handle sensors, switches, and relays carefully. Do not drop them or strike them against other objects.

## Wiring Harness

### Wiring color codes

- Two-color wires are indicated by a two-color code symbol.
- The first letter indicates the base color of the wire and the second the color of the stripe.

CODE	COLOR	CODE	COLOR
B	Black	O	Orange
BR	Brown	P	Pink
G	Green	R	Red
GY	Gray	V	Violet
L	Blue	W	White
LB	Light Blue	Y	Yellow
LG	Light Green		

